

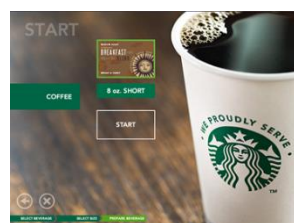

# STARBUCKS INTERACTIVE CUP® DIGITAL BREWER USER CARD

The Starbucks Interactive Cup® Digital Brewer is fully automatic, so there's no measuring, no separate grinding and mess – just a consistently delicious cup of Starbucks quality coffee or cocoa

## Brewing Instructions

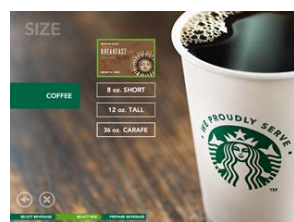
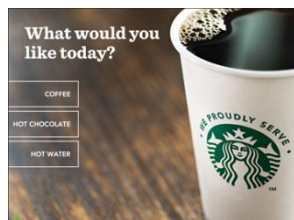

### PLACE YOUR CUP

- Center your cup or mug on the cup stand
- Raise the cup stand and place your carafe directly on the drip tray

### Carafe or Travel Mug

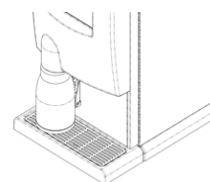

### STEP 1: CHOOSE A BEVERAGE

Coffee  
Hot Chocolate  
Hot Water

### STEP 2: CHOOSE A BLEND

Blend 1  
Blend 2  
Blend 3  
Mix Two

### Paper Cup or Mug

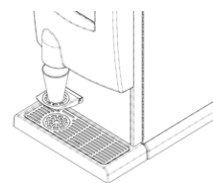

### STEP 3: CHOOSE A SIZE

Short: 8oz  
Tall: 12oz  
Carafe: 36oz

- *Cocoa option not available in Carafe size*

### STEP 4: BREW

- Push START to begin the brew cycle or CANCEL to return to STEP 1
- While Brewing, the cup will illuminate and the monitor will display a video and progress bar. No other features are available during the brewing process

## Loading Product

1. Use the key provided to unlock the hopper of canister you wish to fill
2. Lift the lid and carefully pour Starbucks products into the hopper or canister until it reaches 1 inch from the top
3. Make sure the lid fully closes. Do not overfill.
4. Lock the hopper or canister cover.
5. Clean any spills on the top of the machine immediately.

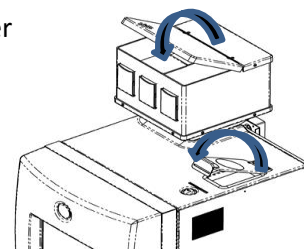

To prevent coffee beans from falling into the cocoa canister, and eventually obstructing the cocoa dispensing tube, always make sure that there are no beans in the cocoa lock area.

## Daily Cleaning And Maintenance

For everyone to enjoy a delicious cup of Starbucks® coffee or cocoa at the touch of a button, any time of day, we recommend completing the following steps daily.

### Cleaning the Exterior of the Starbucks Interactive Cup® Digital Brewer

It is important to keep the machine and its surroundings clean and tidy to ensure consistent product quality.

To minimize scratching and preserve appearance, we recommend using a clean damp sponge or soft cloth lightly treated with a nonabrasive detergent for cleaning the exterior of the unit. After removing all food soils, thoroughly dry with a clean, soft cloth.



- ❖ Abrasive products such as automatic dishwashing detergent, abrasive scrubs or brushes, will damage the machine's finish.
- ❖ Parts for this brewer are **NOT** dishwasher safe

### Daily Cleaning Checklist

- Machine exterior
- Display screen
- Rinse cycle
- Clean drip tray
- Refill all hoppers
- Refill cocoa canister
- Inspect filter paper

### Cleaning the Drip Tray

**WARNING!** Drip tray may be full. Use caution and keep it level to avoid spilling.

1. Remove the drip tray by lifting gently and pulling it out from underneath the door
2. Rinse both parts under hot water and dry thoroughly with a clean dry cloth
3. Reinstall the drip tray onto the machine and make sure that both prongs are secure and that the side skirts are well aligned.

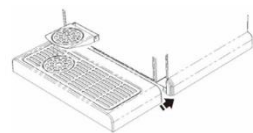

### Perform Rinse Cycle

Access the *Service Screen* by pushing the white button on the door inside of the machine

1. Place a large enough container under the spout.
- **WARNING: Rinse water will be hot!**
1. Push RINSE button on display screen
  2. Follow instructions on screen
  3. When cycle is complete, press EXIT SERVICE MODE

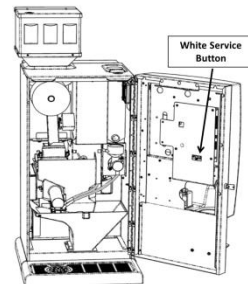

### Cleaning the Display Screen

Use a dry microfiber cloth like the one that came with the machine, **only!**

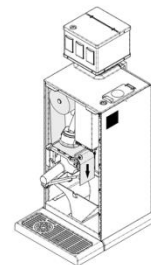

### Changing Filter Paper

**Only use Starbucks Interactive Cup® filter paper (4 1/16" W)**

1. Open brewer & place new paper roll on bracket so it dispenses on the left hand side.
2. Access the *Service Screen* by pushing the white button on the door inside of the machine
3. Press FILTER PAPER INSTALL on the display screen and follow instructions displayed
4. When paper is installed, press EXIT SERVICE MODE on the display screen

## Weekly Cleaning And Beyond

A regular cleaning schedule should be followed to honor the machine's warranty and ensure consistent product quality and maintain safety levels. A weekly, monthly and quarterly machine maintenance schedule, along with detailed instructions, can be found in the machine's user manual.